

**ADDENDUM 1  
TO THE CONTRACT PROVISIONS AND CONTRACT PLANS**

**FOR**

**NORTHSHORE UTILITY DISTRICT  
CONTRACT NO. 2020-01; LAKE FOREST PARK RESERVOIR AND BOOSTER  
STATION UPGRADES**

**G&O #19670**

**ISSUED THIS DATE: WEDNESDAY, NOVEMBER 4, 2020**

**BID OPENING: 2:00 P.M. (LOCAL TIME) ON  
TUESDAY, NOVEMBER 10, 2020  
NORTHSHORE UTILITY DISTRICT  
6830 NE 185<sup>TH</sup> STREET  
KENMORE, WASHINGTON 98028**



11/04/2020

**Bidder shall acknowledge receipt of this Addendum on Page Prop 3 of the Proposal.**

---

TO PROSPECTIVE BIDDERS:

The attention of all prospective bidders on the above project is directed to the following additions and modifications to the Contract Provisions and Contract Plans.

**I. ADDITIONS, MODIFICATIONS, AND/OR DELETIONS TO THE  
ENGINEERING SPECIFICATIONS**

**ITEM 1:**

Page 02820-1, Engineering Specifications Section 02820-2.1, Fencing

**REVISE** the first sustenance of the first paragraph as shown below (added text is italicized, deleted text is shown as strike out):

“The fence shall have continuous *green vinyl coated* chain link wire, tension wire and three strands of barbed wire supported on angled extension arms.”

**ITEM 2:**

Page 02820-1, Engineering Specifications Section 02820-2.1, Fencing

**REVISE** the second paragraph as shown below (added text is italicized, deleted text is shown as strike out):

“~~Fabric~~ *Rails, posts, and accessories* shall be galvanized with 1.8 ounces per square foot.”

**II. ADDITIONS, MODIFICATIONS, AND/OR DELETIONS TO THE CONTRACT PLANS**

**ITEM 1:**

**SHEET 6 OF 28, RESERVOIR DETAILS, DETAIL 1**

**REVISE** note 7 on Detail 1 as shown below (added text is italicized, deleted text is shown as strike out):

“7. NEW CHAIN LINK MESH SHALL BE ~~2” OPEN X 9 GAUGE GALVANIZED STYLE~~ *PER SPECIFICATIONS.*”

**ITEM 2:**

**SHEET 6 OF 28, RESERVOIR DETAILS, DETAIL 3**

**REVISE** note 7 on Detail 3 as shown below (added text is italicized, deleted text is shown as strike out):

“7. NEW CHAIN LINK MESH SHALL BE ~~2” OPEN X 9 GAUGE GALVANIZED STYLE~~ *PER SPECIFICATIONS.*”

**ITEM 3:**

**SHEET 7 OF 28, RESERVOIR DETAILS**

**DELETE** Sheet 7 of 28 in its entirety and **REPLACE** with the attached revised Sheet 7 of 28.

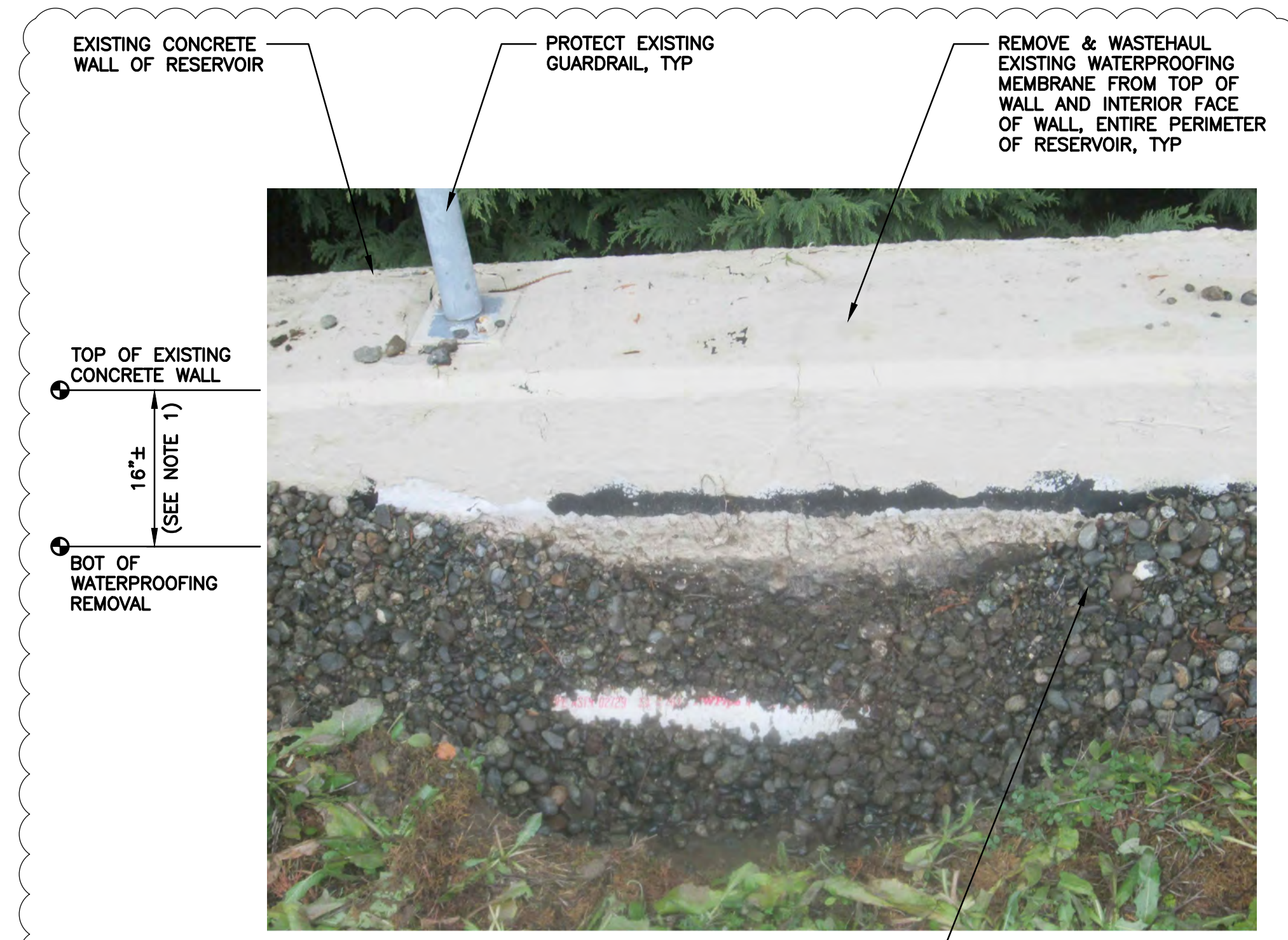

REMOVE EXISTING DRAIN ROCK AS REQUIRED. REINSTALL EXISTING DRAIN ROCK AFTER COMPLETION OF WATERPROOFING. TOP OF EXISTING DRAIN ROCK IS 4"± BELOW TOP OF EXISTING CONCRETE WALL.

**NOTE:**

1. FIELD VERIFY HEIGHT OF EXISTING WATERPROOFING MEMBRANE TO REMOVE FROM INTERIOR FACE OF WALL. FAILED WATERPROOFING SHALL BE REMOVED AND SUFFICIENT AMOUNT OF EXISTING MEMBRANE SHALL REMAIN TO ACHIEVE LAP WITH NEW EPDM MEMBRANE.

**DEMOLITION**

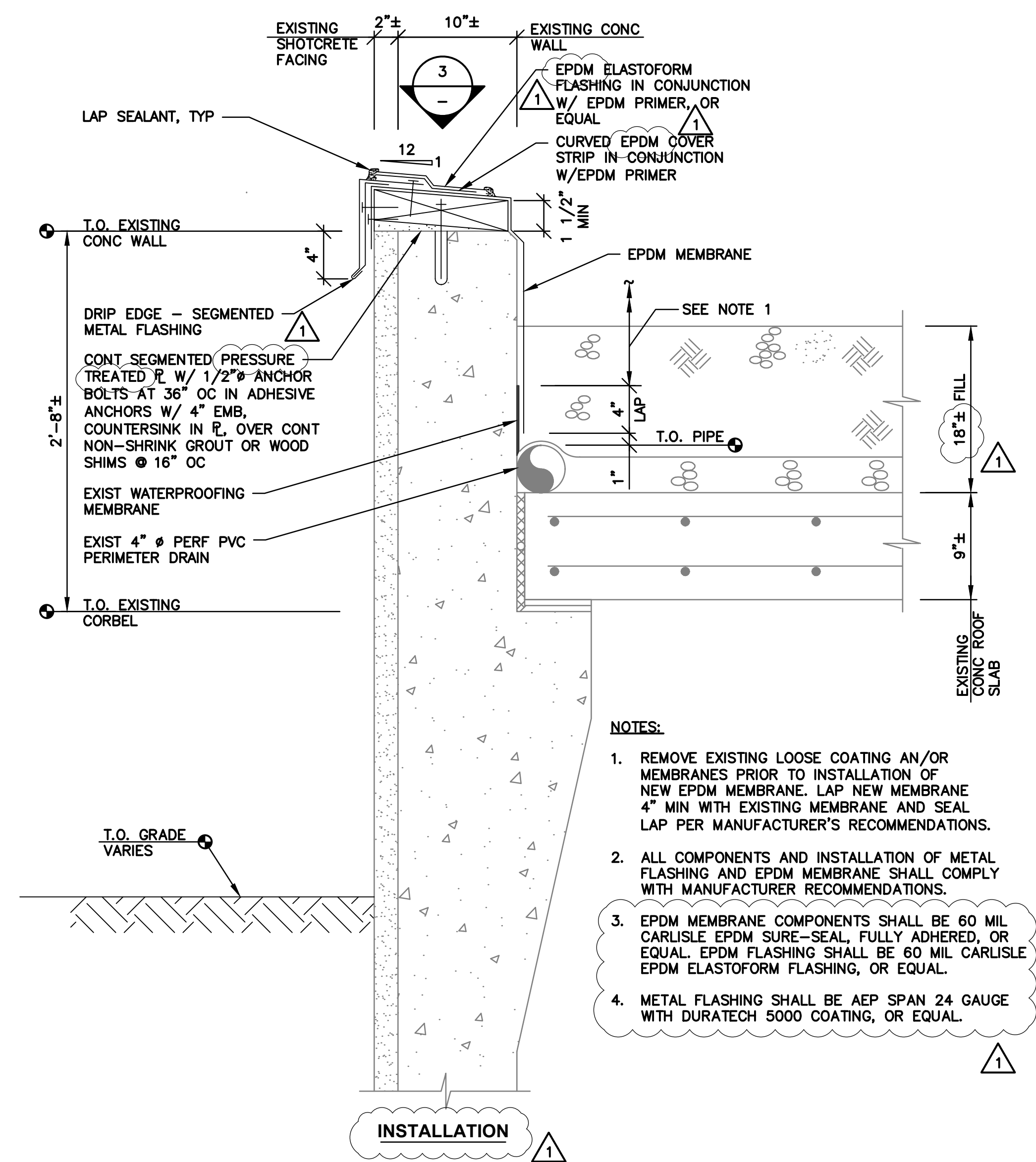

**NOTES:**

1. REMOVE EXISTING LOOSE COATING AN/OR MEMBRANES PRIOR TO INSTALLATION OF NEW EPDM MEMBRANE. LAP NEW MEMBRANE 4" MIN WITH EXISTING MEMBRANE AND SEAL LAP PER MANUFACTURER'S RECOMMENDATIONS.
2. ALL COMPONENTS AND INSTALLATION OF METAL FLASHING AND EPDM MEMBRANE SHALL COMPLY WITH MANUFACTURER RECOMMENDATIONS.
3. EPDM MEMBRANE COMPONENTS SHALL BE 60 MIL CARLISLE EPDM SURE-SEAL, FULLY ADHERED, OR EQUAL. EPDM FLASHING SHALL BE 60 MIL CARLISLE EPDM ELASTOFORM FLASHING, OR EQUAL.
4. METAL FLASHING SHALL BE AEP SPAN 24 GAUGE WITH DURATECH 5000 COATING, OR EQUAL.

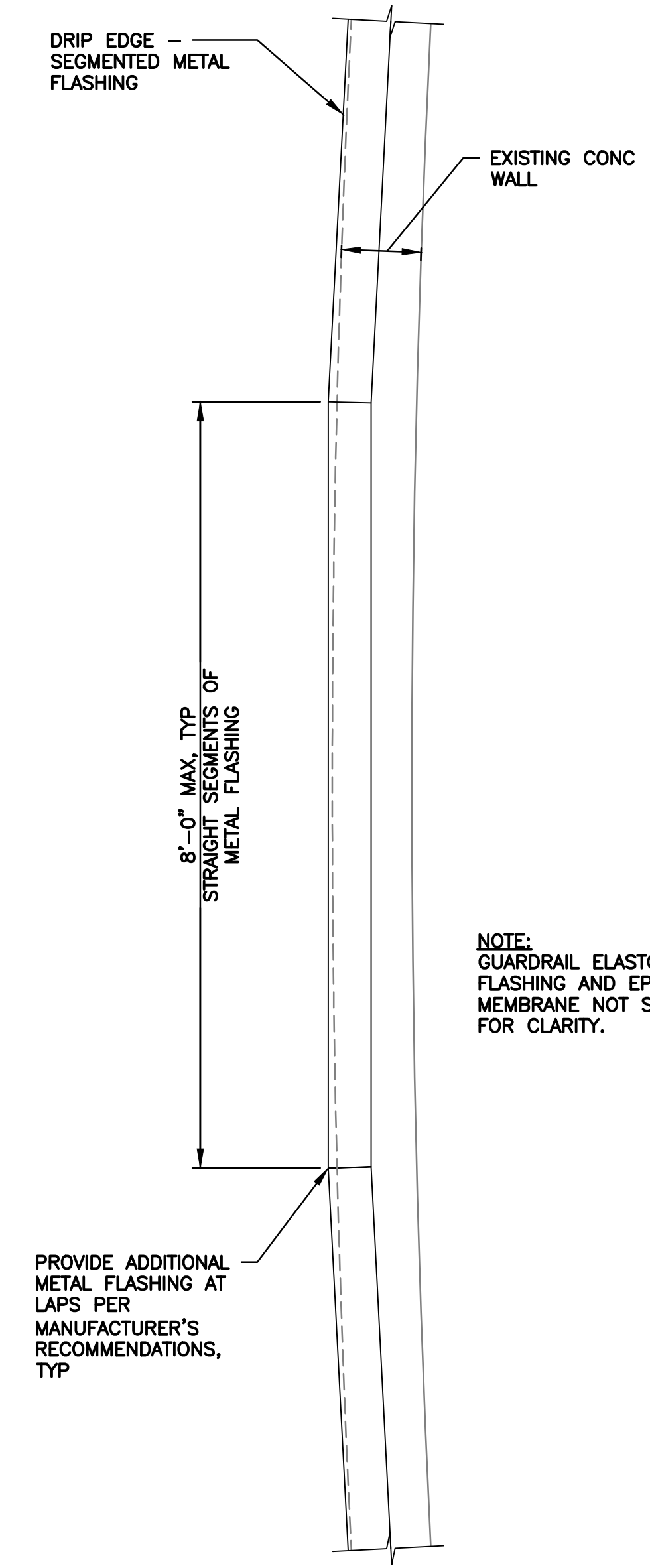

NOTE: GUARDRAIL ELASTOFORM FLASHING AND EPDM MEMBRANE NOT SHOWN FOR CLARITY.

PROVIDE ADDITIONAL METAL FLASHING AT LAPS PER MANUFACTURER'S RECOMMENDATIONS, TYP

**1 TYPICAL WATERPROOFING REPAIR SECTION**  
SCALE: 1 1/2"=1'-0"

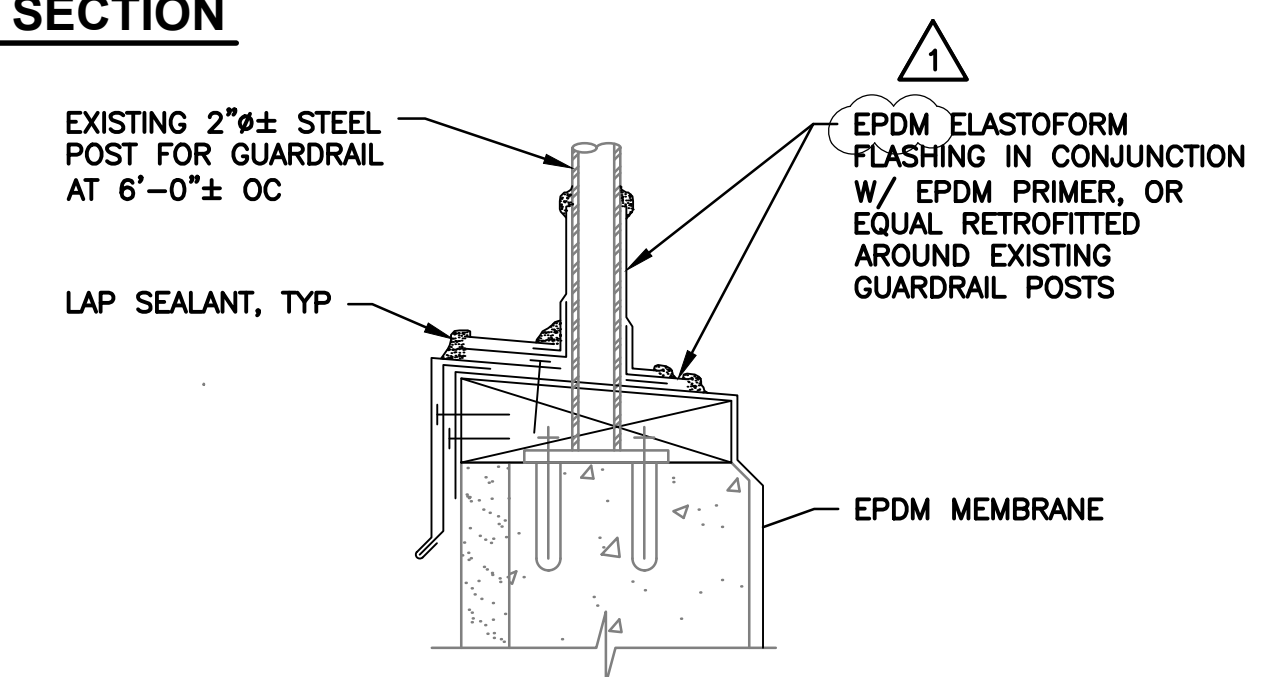

**NOTE:**

1. SEE 1 FOR BALANCE OF INFO.

**2 TYPICAL WATERPROOFING AT GUARDRAIL POST**  
SCALE: 1 1/2"=1'-0"

**3 TYPICAL WATERPROOFING PLAN DETAIL**  
SCALE: 3/4"=1'-0"

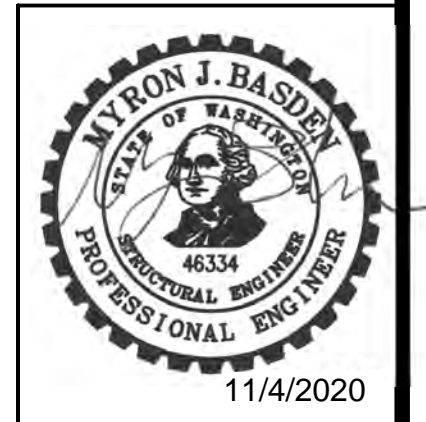

NO	BY	APPD	REVISION	DATE
1	RAH	MJB	ADDENDUM NO. 1	
<b>BID SET</b>				

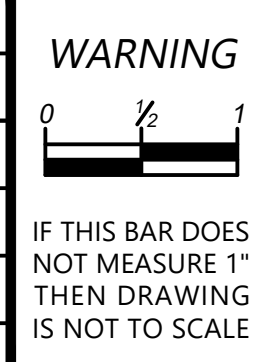

DESIGNED BY	MJB
DRAWN BY	RAH
CHECKED BY	MJB
APPROVAL	MJB
DATE	OCT 2020



**NORTHSHORE UTILITY DISTRICT**  
6830 NE 185th St. P.O. Box 82489  
Kenmore, WA 98028-2684 Kenmore, WA 98028-2684  
Ph: (425) 398-4400 | Fax: (425) 398-4430 | [www.nud.net](http://www.nud.net)

CONTRACT 2020-01  
LAKE FOREST PARK RESERVOIR AND BOOSTER STATION UPGRADES

**RESERVOIR DETAILS**

BASE MAP A2
C1502
SHEET
7 OF 28